

Złączki gwintowane

333

Mufa gwint wewnętrzny DIN 2986.



NW	d1	d2	L
6	1/8"	14,0 mm	17 mm
8	1/4"	17,0 mm	25 mm
10	3/8"	21,3 mm	26 mm
15	1/2"	26,4 mm	34 mm
20	3/4"	31,8 mm	36 mm
25	1"	39,5 mm	43 mm
32	1 1/4"	48,3 mm	48 mm
40	1 1/2"	54,5 mm	48 mm
50	2"	66,3 mm	56 mm
65	2 1/2"	82,0 mm	66 mm
80	3"	95,0 mm	71 mm
100	4"	122,0 mm	83 mm

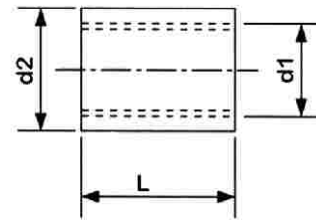

335

Mufa redukująca gwint wewnętrzny DIN



d2 - d1	L	d2 - d1	L
1/4" - 1/8"	27 mm	1 1/2" - 3/4"	56 mm
3/8" - 1/8"	34 mm	- 1"	56 mm
- 1/4"	34 mm	- 1 1/4"	56 mm
1/2" - 1/4"	34 mm	2" - 1"	66 mm
- 3/8"	34 mm	- 1 1/4"	66 mm
3/4" - 3/8"	38 mm	- 1 1/2"	66 mm
- 1/2"	45 mm	2 1/2" - 1 1/4"	70 mm
1" - 3/8"	45 mm	- 1 1/2"	70 mm
- 1/2"	45 mm	- 2"	70 mm
- 3/4"	50 mm	3" - 2"	72 mm
1 1/4" - 1/2"	50 mm	- 2 1/2"	72 mm
- 3/4"	50 mm		
- 1"	50 mm		

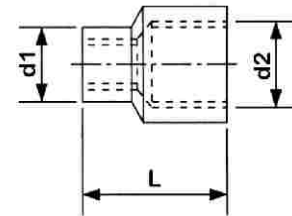

337

Końcówka do węża z nakrętką gwint zewnętrzny.



NW	d	E	L	SW
8	1/4"	9 mm	48 mm	15 mm
10	3/8"	11 mm	53 mm	19 mm
15	1/2"	14 mm	65 mm	23 mm
20	3/4"	20 mm	70 mm	29 mm
25	1"	26 mm	75 mm	38 mm
32	1 1/4"	33 mm	80 mm	46 mm
40	1 1/2"	39 mm	95 mm	50 mm
50	2"	51 mm	105 mm	60 mm
65	2 1/2"	63 mm	110 mm	80 mm
80	3"	76 mm	120 mm	95 mm

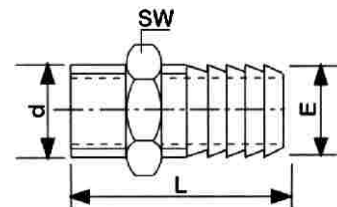

337 S

Końcówka do węża do przyspawania.



NW	d	L
8	13,5 mm	48 mm
10	17,2 mm	53 mm
15	21,3 mm	65 mm
20	26,9 mm	70 mm
25	33,7 mm	75 mm
32	42,4 mm	80 mm
40	48,3 mm	95 mm
50	60,3 mm	105 mm
65	76,1 mm	110 mm
80	88,9 mm	120 mm

