

Złączki gwintowane

gwint BSP, ciśnienie PN10

NW	d1	L1
6	1/8"	18 mm
8	1/4"	18 mm
10	3/8"	22 mm
15	1/2"	25 mm
20	3/4"	30 mm
25	1"	35 mm
32	1 1/4"	38 mm
40	1 1/2"	38 mm
50	2"	45 mm
65	2 1/2"	55 mm
80	3"	60 mm
100	4"	70 mm

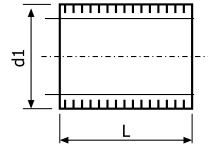

309

Nypel pełny
gwint zewnętrzny DIN 2982.
Wykonanie stal 316.



NW	d1	d2	L1
6	1/8"	10,2 mm	40 mm
8	1/4"	13,5 mm	40 mm
10	3/8"	17,2 mm	40 mm
15	1/2"	21,3 mm	60 mm
20	3/4"	26,9 mm	60 mm
25	1"	33,7 mm	60 mm
32	1 1/4"	42,4 mm	80 mm
40	1 1/2"	48,3 mm	80 mm
50	2"	60,3 mm	100 mm
65	2 1/2"	76,1 mm	100 mm
80	3"	88,9 mm	120 mm
100	4"	114,3 mm	120 mm

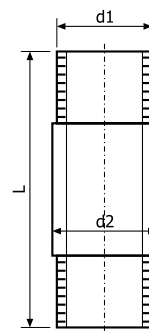

310

Nypel dwustronny
gwint zewnętrzny DIN 2982. Wykonanie
stal 316 lub 304.



NW	d1	L	SW
6	1/8"	33 mm	31 mm
8	1/4"	45 mm	35 mm
10	3/8"	45 mm	38 mm
15	1/2"	43 mm	42 mm
20	3/4"	46 mm	49 mm
25	1"	51 mm	60 mm
32	1 1/4"	56 mm	70 mm
40	1 1/2"	59 mm	77 mm
50	2"	67 mm	91 mm
65	2 1/2"	83 mm	110 mm
80	3"	97 mm	126 mm

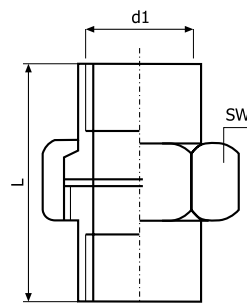

311

Śrubunek króćce płaskie,
gwint wewnętrzny.
Wykonanie stal 316.

