

Złączki gwintowane

303

Kolano 45° gwint wewnętrzny DIN 2987



NW	d1	L
8	1/4"	19 mm
10	3/8"	20 mm
15	1/2"	23 mm
20	3/4"	25 mm
25	1"	29 mm
32	1 1/4"	33 mm
40	1 1/2"	37 mm
50	2"	43 mm
65	2 1/2"	56 mm
80	3"	68 mm

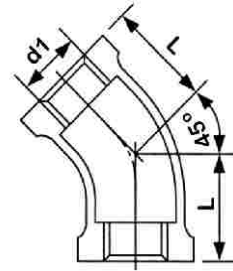

304

Kolano nypłowe 90° gwint wewn/zewn DIN 2987.



NW	d1	L1
6	1/8"	18 mm
8	1/4"	21 mm
10	3/8"	24 mm
15	1/2"	28 mm
20	3/4"	33 mm
25	1"	38 mm
32	1 1/4"	45 mm
40	1 1/2"	49 mm
50	2"	57 mm
65	2 1/2"	68 mm
80	3"	80 mm
100	4"	130 mm

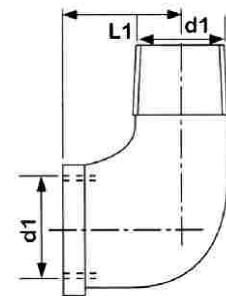

305

Kolano długie 90° gwint zewnętrzny DIN 2983.



NW	d1	L1
8	1/4"	60 mm
10	3/8"	70 mm
15	1/2"	80 mm
20	3/4"	100 mm
25	1"	120 mm
32	1 1/4"	140 mm
40	1 1/2"	160 mm
50	2"	190 mm
65	2 1/2"	240 mm
80	3"	290 mm

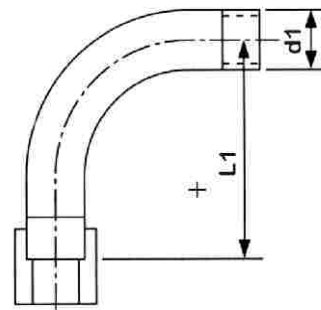

307

Trójnik gwint wewnętrzny DIN 2987.



NW	d1	L1
6	1/8"	18 mm
8	1/4"	21 mm
10	3/8"	25 mm
15	1/2"	28 mm
20	3/4"	33 mm
25	1"	38 mm
32	1 1/4"	45 mm
40	1 1/2"	50 mm
50	2"	58 mm
65	2 1/2"	70 mm
80	3"	78 mm
100	4"	96 mm

